

PROFILE PH2 - ROAD 2.5
Horizontal Scale 1:1000
Vertical Scale 1:100

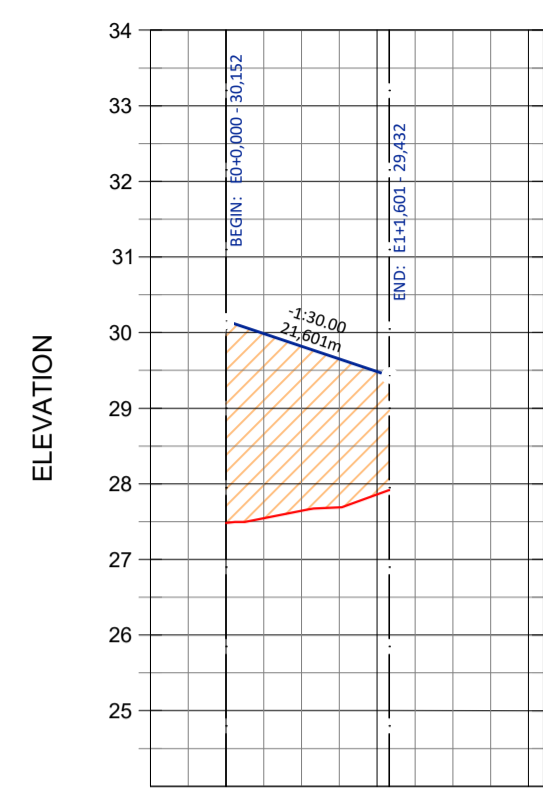

CHAINAGE	0.00	20.00	40.00
EXISTING GROUND	27.484	27.860	
PROPOSED GROUND	30.152	29.645	
CUT	2.67		
FILL		1.03	

PROFILE PH2 - ROAD 2.6
Horizontal Scale 1:1000
Vertical Scale 1:100

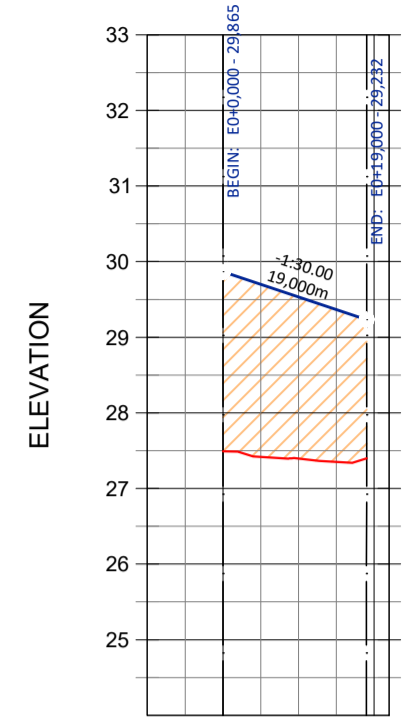

CHAINAGE	0.00	20.00
EXISTING GROUND	27.490	
PROPOSED GROUND	29.895	
CUT	2.37	
FILL		

PROFILE PH2 - ROAD 3.1
Horizontal Scale 1:1000
Vertical Scale 1:100

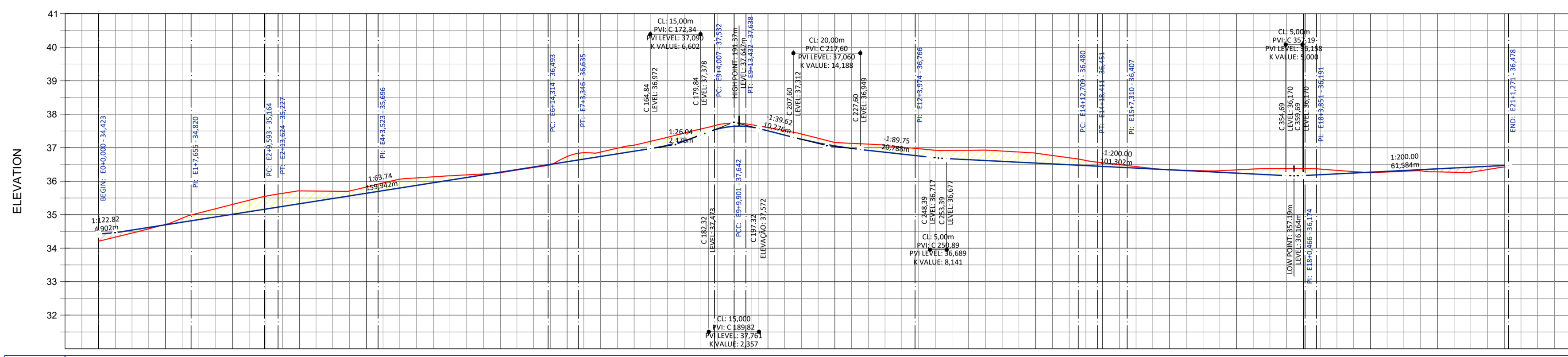

CHAINAGE	0.00	20.00	40.00	60.00	80.00	100.00	120.00	140.00	160.00	180.00	200.00	220.00	240.00	260.00	280.00	300.00	320.00	340.00	360.00	380.00	400.00	420.00	440.00	
EXISTING GROUND	34.206	34.711	35.305	35.709	35.829	36.131	36.254	36.736	37.078	37.561	37.603	37.157	37.016	36.925	36.838	36.561	36.340	36.339	36.382	36.252	36.279	36.424		
PROPOSED GROUND	34.423	34.700	35.014	35.327	35.641	35.955	36.269	36.582	36.896	37.210	37.524	37.838	38.152	38.466	38.780	39.094	39.408	39.722	40.036	40.350	40.664	40.978	41.292	
CUT	0.22																							
FILL		0.01	0.29	0.38	0.19	0.18	0.01	0.15	0.18	0.10	0.10	0.10	0.21	0.28	0.29	0.11	0.00	0.10	0.21	0.02	0.09	0.05		

PROFILE PH2 - ROAD 3.2
Horizontal Scale 1:1000
Vertical Scale 1:100

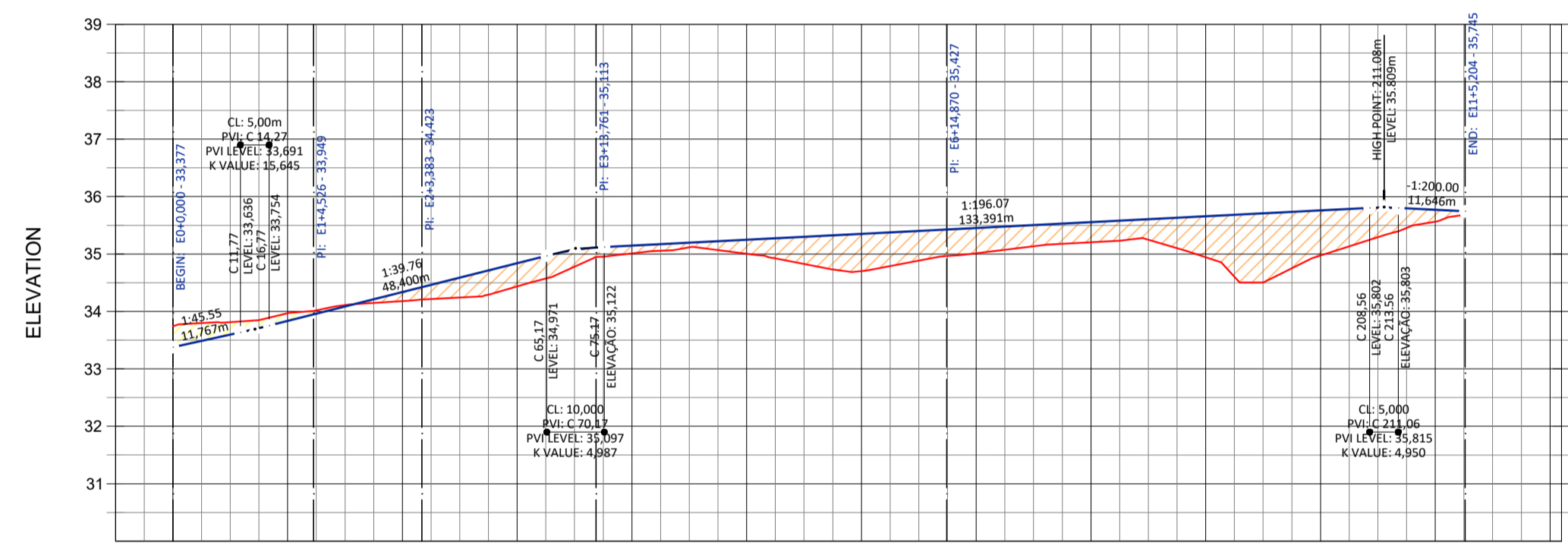

CHAINAGE	0.00	20.00	40.00	60.00	80.00	100.00	120.00	140.00	160.00	180.00	200.00	220.00	240.00
EXISTING GROUND	33.744	33.909	34.178	34.436	34.694	34.952	35.210	35.468	35.726	35.984	36.242	36.500	36.758
PROPOSED GROUND	33.377	33.835	34.293	34.751	35.209	35.667	36.125	36.583	37.041	37.499	37.957	38.415	38.873
CUT	0.37												
FILL		0.13	0.16	0.40	0.13	0.25	0.05	0.44	0.35	0.71	0.79	0.21	

PROFILE PH2 - ROAD 3.3
Horizontal Scale 1:1000
Vertical Scale 1:100

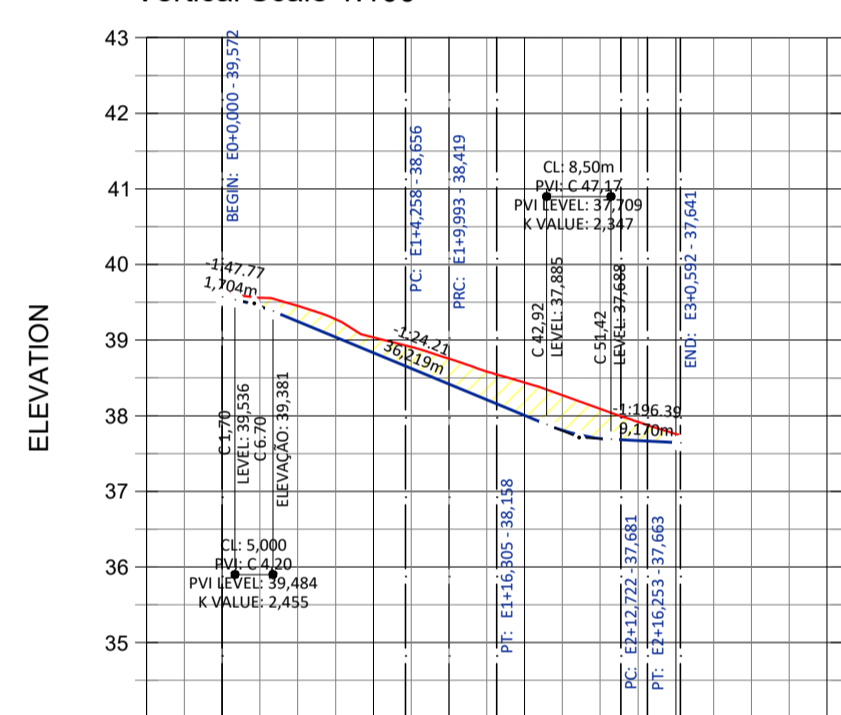

CHAINAGE	0.00	20.00	40.00	60.00	80.00
EXISTING GROUND	39.645	39.006	38.438	37.760	
PROPOSED GROUND	39.572	38.832	38.092	37.644	
CUT	0.07				
FILL		0.20	0.43	0.12	

PROFILE PH2 - ROAD 3.4
Horizontal Scale 1:1000
Vertical Scale 1:100

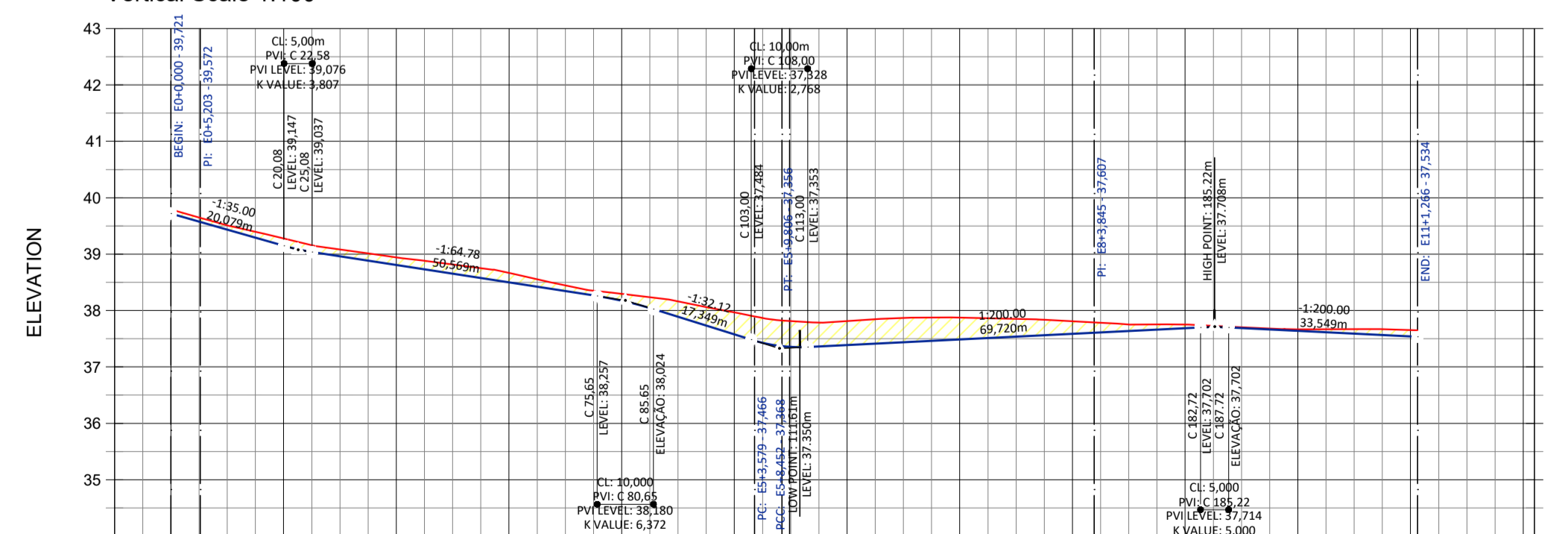

CHAINAGE	0.00	20.00	40.00	60.00	80.00	100.00	120.00	140.00	160.00	180.00	200.00	220.00	240.00
EXISTING GROUND	39.792	39.279	38.940	38.665	38.294	37.995	37.813	37.873	37.810	37.752	37.688	37.654	37.655
PROPOSED GROUND	39.721	39.150	38.807	38.468	38.175	37.877	37.588	37.488	37.398	37.298	37.198	37.098	37.098
CUT	0.07												
FILL		0.13	0.13	0.17	0.12	0.39	0.43	0.38	0.22	0.08	0.03	0.11	

PROFILE PH2 - ROAD 3.5
Horizontal Scale 1:1000
Vertical Scale 1:100

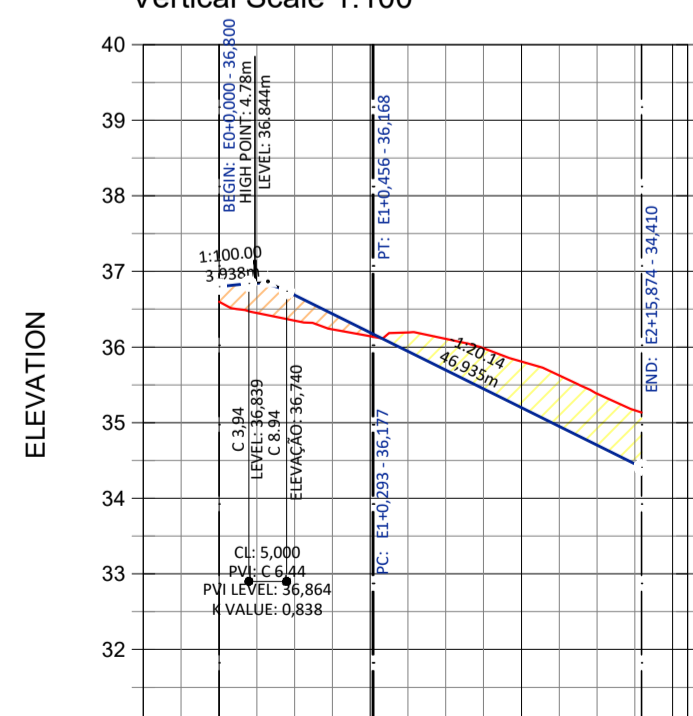

CHAINAGE	0.00	20.00	40.00	60.00
EXISTING GROUND	36.801	36.144	35.807	
PROPOSED GROUND	36.800	36.191	35.198	
CUT	0.20			
FILL		0.05	0.61	

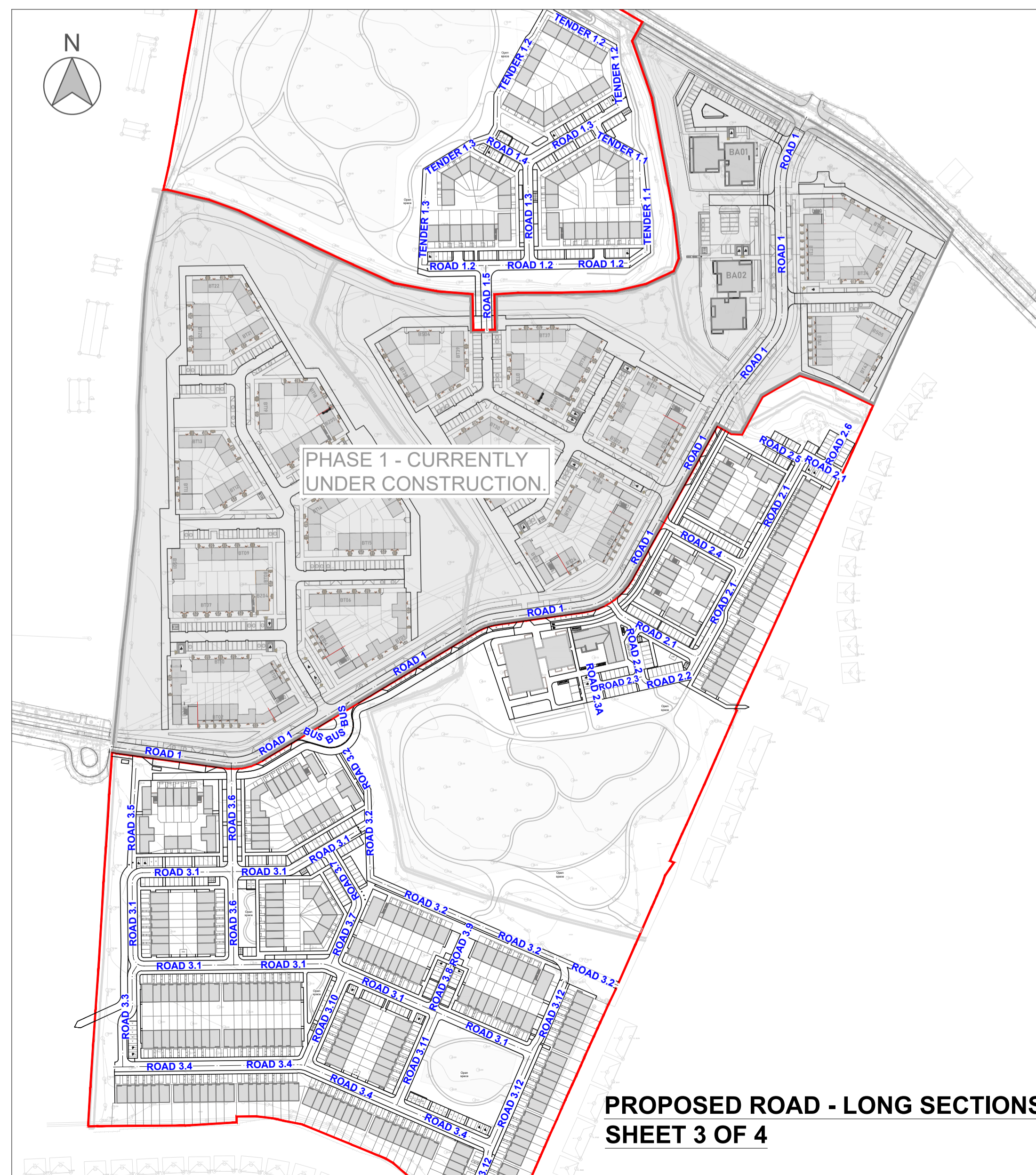

PROPOSED ROAD - LONG SECTIONS
SHEET 3 OF 4

- NOTES**
- NO PART OF THIS DRAWING MAY BE REPRODUCED OR TRANSMITTED IN ANY FORM OR STORED IN ANY RETRIEVAL SYSTEM OF ANY NATURE WITHOUT THE WRITTEN PERMISSION OF AKM DESIGN GROUP. ALL WORKS TO PRIVATE ROADS WITHIN RESIDENTIAL DEVELOPMENT TO BE TO LOCAL AUTHORITY STANDARDS & RECOMMENDATIONS FOR SITE DEVELOPMENT WORKS.
 - ALL DIMENSIONS ARE IN M UNLESS OTHERWISE NOTED.
 - THE CONTRACTOR SHALL CHECK ALL DIMENSIONS PRIOR TO COMMENCEMENT OF CONSTRUCTION. DISCREPANCIES SHALL BE REPORTED TO THIS OFFICE IN WRITING.
 - ALL WORKS TO NATIONAL AND REGIONAL ROADS TO BE CONSTRUCTED IN ACCORDANCE WITH THE NRA SPECIFICATION FOR ROAD WORKS UNLESS OVERRIDDEN BY LOCAL OVERSEEING AUTHORITY'S STANDARDS. ALL WORKS TO PRIVATE ROADS WITHIN RESIDENTIAL DEVELOPMENT TO BE TO LOCAL AUTHORITY STANDARDS & RECOMMENDATIONS FOR SITE DEVELOPMENT WORKS.
 - ALL ROAD MARKINGS & SIGNS SHALL COMPLY FULLY WITH THE TRAFFIC SIGNS MANUAL PUBLISHED BY THE DEPARTMENT OF TRANSPORT, JUNE 2010.
 - SIGNS & MARKINGS: CONTRACTOR TO CONFIRM PRECISE SETTING OUT WITH EMPLOYERS REPRESENTATIVE PRIOR TO COMPLETION.
 - ALL SIGNS TO BE MOUNTED ON 76mm GALVANIZED STEEL POSTS WITH COLORED SLEEVES U.N.O. TO SPECIFICATION AND IN ACCORDANCE WITH THE TRAFFIC SIGNS MANUAL: MOUNTING HEIGHT TO BOTTOM OF SIGN = 2.3m U.N.O.
 - ALL TRAFFIC MANAGEMENT TO COMPLY FULLY WITH THE PROVISIONS OF CHAPTER 8 OF THE TRAFFIC SIGNS MANUAL.
 - ALL CO-ORDINATES ARE TO ITM (IRISH TRANSVERSE MERCATOR).
 - ALL LEVELS ARE TO ORDNANCE DATUM AND ARE IN METERS.
 - ALL EXISTING SIGNS (INCLUDING POLES) AND MARKINGS TO BE TAKEN UP OR COVERED AND TEMPORARY MEASURES APPLIED IN ACCORDANCE WITH CONTRACTORS TRAFFIC MANAGEMENT PLAN. THE CONTRACTOR MAY USE EXISTING SIGNAGE AS PART OF THEIR TRAFFIC MANAGEMENT PLAN.
 - ALL EXISTING CHAMBERS AND ACCESS POINTS TO REMAIN CLEAR OF OBSTRUCTION THROUGHOUT WORKS. CHAMBERS SHALL BE REBUILT/RETAINED IN POSITION IDENTIFIED ON SITE SERVICES LAYOUT DRAWING.
 - ALL PEDESTRIAN, CYCLE AND VEHICULAR ROUTES MUST BE RETAINED IN ACCORDANCE WITH APPROVED TRAFFIC MANAGEMENT PLAN.
 - ALL MATERIALS TO BE DISPOSED OFF SITE SHALL BE TAKEN TO A LICENSED FACILITY APPROVED BY THE LOCAL OVERSEEING AUTHORITY.

LEGEND

- EXISTING GROUND LEVEL
- PROPOSED ROAD LEVEL
- CUT
- FILL

COPYRIGHT RESERVED. ALL DRAWINGS TO BE READ IN CONJUNCTION WITH ARCHITECTURE, STRUCTURAL ENGINEERS & MECHANICAL ENGINEERS DETAILS.

DO NOT SCALE DRAWING. USE FIGURED DIMENSIONS ONLY. ALL DISCREPANCIES TO BE REPORTED TO AKM DESIGN GROUP IMMEDIATELY. ALL DIMENSIONS TO BE CHECKED ON SITE BY MAIN CONTRACTOR PRIOR TO CONSTRUCTION. MAIN CONTRACTOR IS RESPONSIBLE FOR SET-OUT.

DESCRIPTION	REV	DATE
FIRST ISSUE	00	04/26

AKM DESIGN GROUP
Innovating tomorrow through design

14 Riverwalk, Citywest, Dublin 24, D24 XN32
T: +353 1 479 6234 E: info@akmdesign.ie akmdesign.ie

STAGE:
S2 - FOR INFORMATION

DRAWN BY: DM	APPROVED BY: CK	AKM JOB NUMBER: 25051
DATE: 04/26	SCALE: Horizontal 1:1000 Vertical 1:200	@ A1
REVISION NUMBER: 00	SEQUENCE NUMBER: 540003	

DOCUMENT NO:
25051-AKM-XXXX-XX-DR-C01-540003

PROJECT TITLE:
25051 - FINGAL MOORETOWN PHASE 2

DRAWING TITLE:
PROPOSED ROAD LONG SECTIONS
SHEET 3 OF 4

CLIENT:
FINGAL COUNTY COUNCIL